

Features

- Full bore 2 Piece ball valve
- 316 Stainless Steel construction
- Flanged Ends according to PN16
- Anti-static device fitted
- ATEX Approved and Fire Safe Design
- ISO5211 actuator mounting pad
- Maximum pressure 40 Bar to 2", 16 Bar rest
- Working temperature -30°C to +180°C

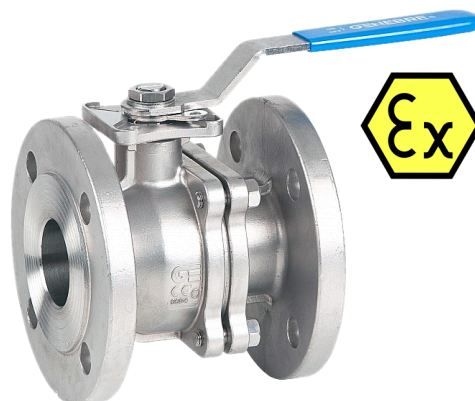

Operation

Turning the hand lever one quarter-turn (90°) rotates the ball from closed to the open position. A locking device allows for pad locking the valve in either the open or closed position for safety lockout applications. Actuators can direct mount to its standard ISO5211 mounting pad and square output shaft.

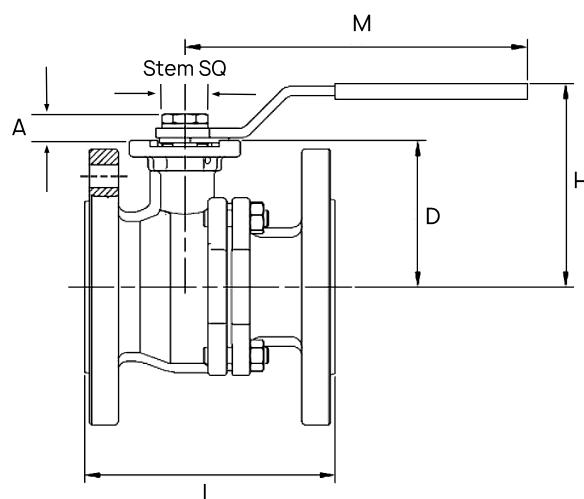

Materials

Body	316 Stainless Steel 1.4408 shot blasted
Ball	316 Stainless Steel 1.4408 polished
Seats	15% Glass Filled PTFE
Stem / Seals	316SS / Viton O-ring, PTFE, Graphite
Lever	Stainless Steel 304SS with Vinyl cover

Manufacturer:

GENEBRE

Dimension Table

Size	PN	H	L	M	D	*ISO5211	*A	*Stem SQ	Torque (Nm)
1/2"	40	85.0	115.0	170.0	46.0	F04	9.5	9	6.3
3/4"	40	85.0	120.0	170.0	51.0	F04/F05	10.0	9	10.0
1"	40	95.0	125.0	170.0	57.0	F04/F05	11.0	11	12.5
1 1/4"	40	106.0	130.0	200.0	71.0	F05/F07	15.5	14	17.5
1 1/2"	40	110.0	140.0	200.0	76.0	F05/F07	15.5	14	25.0
2"	40	118.0	150.0	200.0	83.0	F05/F07	15.5	14	37.5

* 2 1/2" to 8" continued on page 2.....

* Refers to the stem dimensions and actuator mounting

Torque incl SF

Dimension Table continued..

Size	PN	H	L	M	D	*ISO5211	*A	*Stem SQ	Torque (Nm)
2 1/2"	16	170.0	170.0	380.0	119.0	F07/F10	21.0	17	45.0
3"	16	170.0	180.0	380.0	130.0	F07/F10	21.0	17	75.0
4"	16	170.0	190.0	380.0	145.0	F07/F10	21.0	17	118.75
5"	16	200.0	325.0	520.0	163.0	F10/F12	34.0	27	187.5
6"	16	220.0	350.0	620.0	180.0	F10/F12	34.0	27	262.5
8"	16	340.0	400.0	800.0	253.0	F12	27.0	27	512.5
* Refers to the stem dimensions and actuator mountings									Torque incl SF

ATEX Insulation

These ball valves are suitable to be set up in explosive atmospheres: Class I, Zones 1 and 2 according to IEC 60079-10, whose self-ignition temperature is $\leq 190^{\circ}\text{C}$, for the gas group II C, and in Class II, Zones 21 and 22 according to IEC 61241-3, whose self-ignition temperature is $\geq 130^{\circ}\text{C}$ in combustible dust clouds, and $\geq 125^{\circ}\text{C}$ in layers of dust with a maximum thickness of 5 mm. It is recommended to include in the maintenance program a regular cleaning of the surface of the valve to avoid thicker dust layers than 5 mm.

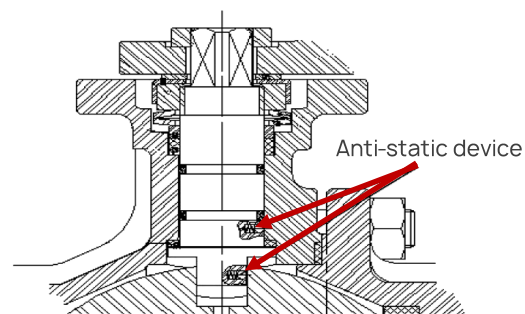

This device ensures the electrical continuity between ball, stem and body, required with flammable fluids.

Pressure Temperature ratings:

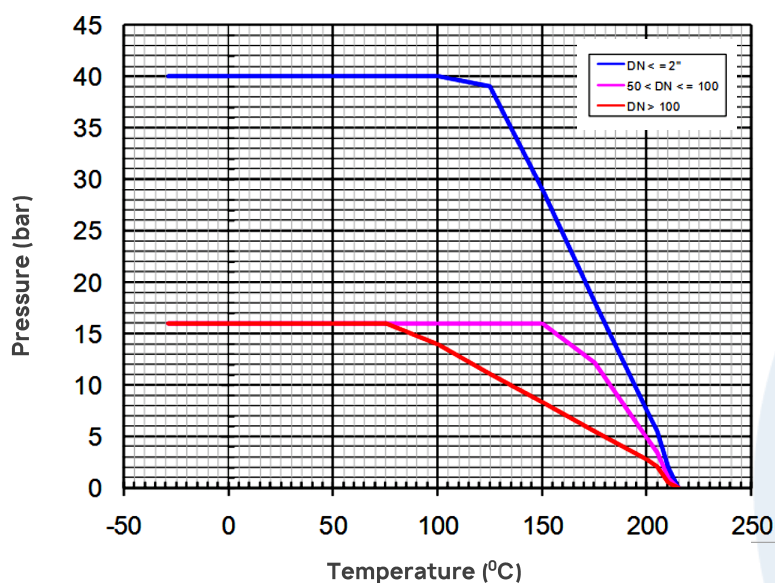

ATEX Technical Data

CE custody file:	LOM 11ATEX0067
ATEX Classification:	II 2 GD
Type of protection:	Constructional safety "c"
T 'amb'. of use:	20°C a/to +60°C
Thermal Class:	T6 to T3 depending on the flowing media
Max. Surface Temperature (Class II):	T130°C in dust cloud - T125°C in dust thickness of 5 mm