



## Main Features:-

- ◆ Flanged PN25/40 ½” to 6”, PN40 8”
- ◆ Cast Steel Body & Bonnet, Stainless Steel Disc, Stem & Seat
- ◆ Graphite Packing
- ◆ Temperature -50°C to 400°C

\*Temperature and pressure determined by valve body, seat etc.



## SERIES: 30109

MANUFACTURER: **AVOL**  
INDUSTRIAL VALVES

## Suitable Applications & Approvals:



Name	Materials
Body	GP240GH
Gland	11SMnPb30
Bonnet	GP240GH
Disc	X20Cr13
Stem	X8CrNiS18-9
Handwheel	Cast Iron
Gland Packing	Graphite
Bellow	X6CrNiTi18-10
Sleeve	11SmnPb30
Bonnet Gasket	Graphite + CrNiSt
Bolt & Nut	A2-70

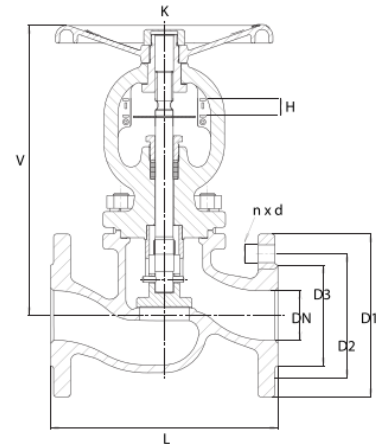

## VALVE DIMENSIONS

DN	D1	D2	D3	nxd	K	H	L	V	Kv	Kg
15	95	65	45	4x14	120	6	130	189	4.3	4.3
20	105	75	58	4x14	120	6	150	189	7	5.1
25	115	85	68	4x14	120	6	160	189	11	5.8
32	140	100	78	4x18	160	10	180	220	17.5	9.5
40	150	110	88	4x18	160	10	200	220	27	9.5
50	165	125	102	4x18	195	16.5	230	295	47	18.5
65	185	145	122	8x18	195	16.5	290	295	68	20.5
80	200	160	138	8x18	280	25	310	368	116	34
100	235	190	162	8x22	280	25	350	368	162	44
125	270	220	188	8x26	350	40	400	523	250	77
150	300	250	218	8x26	350	40	480	523	364	110



T +44 (0)1386 552369

E sales@allvalves.co.uk

W www.allvalves.co.uk

F +44 (0)1386 554227



AVOL valves are our range of industrial valves selected by our experienced technical sales team.

**SERIES: 30109**

## Pressure/ Temperature Chart

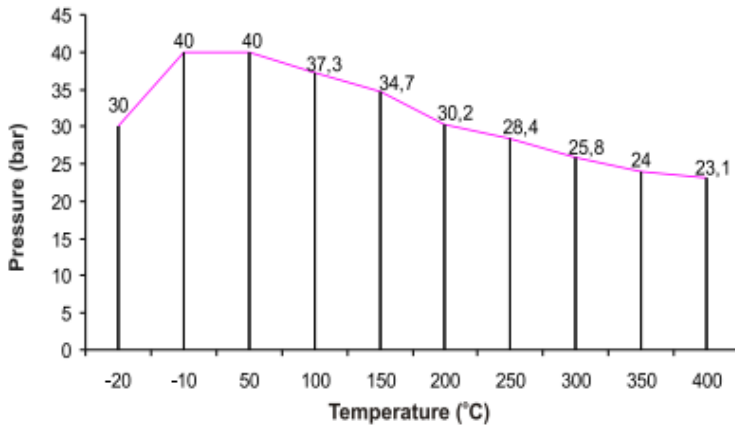

### ALL VALVES ONLINE

Offering a full range of actuated valve packages, manual valve range, pipe fittings and pumps, we have a product for all your requirements. As an ISO 9001-2015 Quality Approved and certified company, All Valves offer a quality service from pre-sale to post sale. Shipping millions of pounds in value of manual valve and actuated valve packages all over the world since its formation, All Valves are a trusted valve and actuator supplier to many companies all over the world. Working with the leading brands in most industries.

PRESSURE/TEMPERATURE CHART



**T** +44 (0)1386 552369

**E** sales@allvalves.co.uk

**W** www.allvalves.co.uk

**F** +44 (0)1386 554227