



## Main Features:-

- ◆ Screwed BSPP Male x Female
- ◆ Stainless Steel Body
- ◆ Reduced Bore, PTFE Seats
- ◆ Short Handle Rated PN63
- ◆ Temperature -10°C to 180°C

\*Temperature and pressure determined by valve body, seat etc.



Also available with red and black handle.

## Suitable Applications & Approvals:



INDUSTRY

## SERIES: 10111

MANUFACTURER: **AVOL**  
INDUSTRIAL VALVES

No	Name	Materials
1	O'Ring	Viton
2	Stem	SS 304
3	Bolt	SS 304
4	Lever	Aluminium Alloy
5	Body	CF8M SS
6	Cap	CF8M SS
7	Ball Seat	RPTFE
8	Ball	CF8M SS
9	Ball Seat	RPTFE
10	Thrust Washer	PTFE

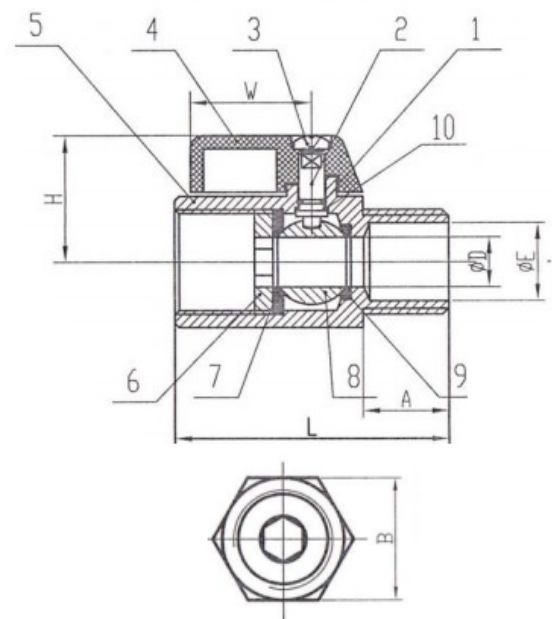

Size	D	L	H	W	B	E	A	Nm	Kg
1/8"	7	40	26.5	22.8	21	7	10	3.4	0.1
1/4"	7	40	26.5	22.8	21	7	10	3.4	0.1
3/8"	7	40	26.5	22.8	21	12	10	3.4	0.1
1/2"	9.2	46	28.3	22.8	24.5	14.5	12	4.5	0.1

## ALL VALVES ONLINE

Offering a full range of actuated valve packages, manual valve range, pipe fittings and pumps, we have a product for all your requirements. As an ISO 9001-2015 Quality Approved and certified company, All Valves offer a quality service from pre-sale to post sale. Shipping millions of pounds in value of manual valve and actuated valve packages all over the world since its formation, All Valves are a trusted valve and actuator supplier to many companies all over the world. Working with the leading brands in most industries.

VALVE DIMENSIONS



T +44 (0)1386 552369

E sales@allvalves.co.uk

W www.allvalves.co.uk

F +44 (0)1386 554227