



Main Features:-

- ◆ Flanged PN16
- ◆ Plated Steel Flanges
- ◆ Stainless Steel Bellow & Inner Sleeve
- ◆ Rated PN16
- ◆ Temperature -80°C to 427°C

*Temperature and pressure determined by valve body, seat etc.



Suitable Applications & Approvals:



SERIES: 100008

MANUFACTURER: **AVOL**
INDUSTRIAL VALVES

Part Material

Flanges	Plated Steel
Inner Sleeve	Stainless Steel
Bellow	Stainless Steel

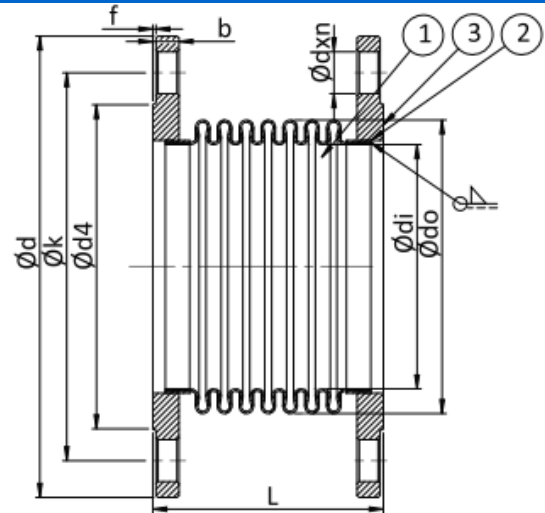

VALVE DIMENSIONS

SIZE	Ød	Øk	Ød4	f	b	Ødxn	Ødi	Ødo	L	Kg
2"	165	125	102	3	18	18x4	60.3	76	110	4.5
2 1/2"	185	145	122	3	18	18x4	76.1	95	195	5
3"	200	160	138	3	20	18x4	88.9	111	195	5
4"	220	180	158	3	20	18x4	114.3	140	195	6.5
5"	250	210	188	3	22	18x4	139.7	164	210	9.1
6"	285	240	212	3	22	23x8	168.3	200	225	10.8
8"	300	295	268	3	24	23x12	219.1	250	245	15.1

*Tolerance Installed



T +44 (0)1386 552369

E sales@allvalves.co.uk

W www.allvalves.co.uk

F +44 (0)1386 554227