



## Main Features:-

- ◆ Carbon Steel ASTM A216 WCB
- ◆ DN15 to DN200 (1/2" to 8")
- ◆ Flanged Class 300 (PN50) RF
- ◆ -29C to +230C rated
- ◆ Anti Static, ATEX and Firesafe



## Approvals & Certification Available:

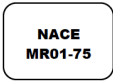

## SERIES: 15047

MANUFACTURER:



ITEM	1/2"	3/4"	1"	1 1/2"	2"	3"	4"	6"	8"	ADDITIONAL SPEC:
P	15	20	25	40	50	78	100	151	203	<ul style="list-style-type: none"> <li>• Full Bore</li> <li>• PTFE seat</li> <li>• 2pc Body Design</li> <li>• Anti Blow Out Stem</li> <li>• Locking Device</li> <li>• ISO 5211 Mounting Pad</li> <li>• 12 Bar rated for Steam</li> <li>• Vacuum 10-2 torr</li> <li>• Exhaust hole in ball</li> <li>• FKM Stem Seal</li> </ul>
L	140	152	165	190	216	283	305	403	502	
L1	60	65	740	80	83	118	133	160	29	
E	170	170	170	215	215	430	466	680	845	
H	68	70	86	1225	127.5	190	192.5	259	319	
H1	31	33	39	48	63	87	108	152	202	
H2	41	43	58.5	86.5	91.5	118.5	144	203	250	
KG	2.5	3.7	4.7	9.4	12.2	25	39.5	88.1	160.5	
Nm	10	13	17	30	49	135	170	308	780	
Kvs m3/h	20	40	75	170	270	1000	1650	4200	9000	
ISO	F05	F05	F05	F07	F07	F10	F10	F12	F14	
C	7	7	8	12	12	15	19	24	32	
H4	18	18	22	33	33	34	45	56	69	
Y	M10	M10	M12	M18	M18	M22	M28	M36	M48	

VALVE DIMENSIONS

## DIMENSIONS

VALVE SIZE (in mm):

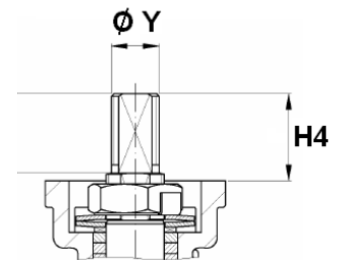
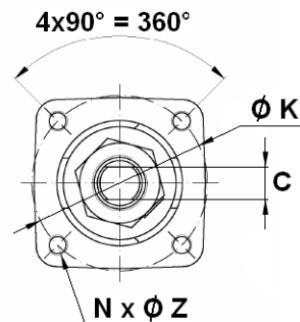
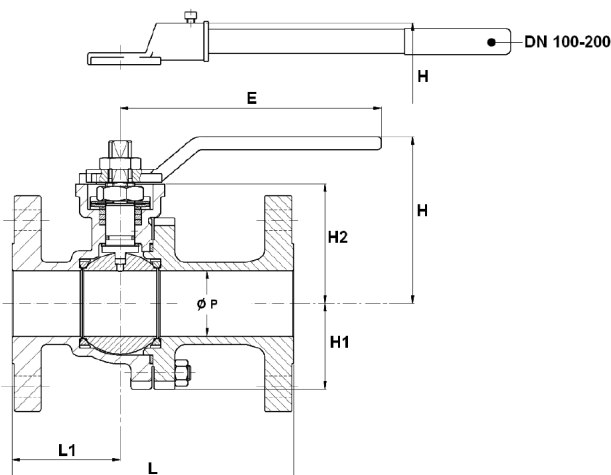

T +44 (0)1386 552369

W www.allvalves.co.uk

E sales@allvalves.co.uk

F +44 (0)1386 554227





Ensure that the valves to be used are appropriate for the conditions of the installation (type of fluid, pressure and temperature). Be sure to have enough valves to be able to isolate the sections of piping as well as the appropriate equipment for maintenance and repair. ☑ Ensure that the valves to be installed are of correct strength to be able to support the capacity of their usage. ☑ **Installation of all circuits should ensure that their function can be automatically tested on a regular basis (at least two times a year).**

## SERIES: 15047

ITEM	Description	Material
1	Body	Carbon Steel ASTM A216 WCB
2	Ends	Carbon Steel ASTM A216 WCB
3	Ball	ASTM A351 CF8M
4	Seat	PTFE
5	Stem	ASTM A479 TYPE 316
6	Stem Thrust Seal	PTFE 25% GLASS FILLED
7	Stem O Ring	FKM
8	Gland Packing	GRAPHITE
9	Gland	AISI 303
10	Elastic Ring	INCONEL 718
12	Gland Nut	AISI 303
12.1	Handle Nut	AISI 303
13	Antifriction Washer	PTFE + 25% GLASS FILLED
14	Handle	NODULAR IRON
15	Stud	A193 GR B7M
16	Nut	A194 GR 2HM
17	Spiral wound gasket	SS 316L + PTFE+ GRAPHITE
18	Bolt	A2

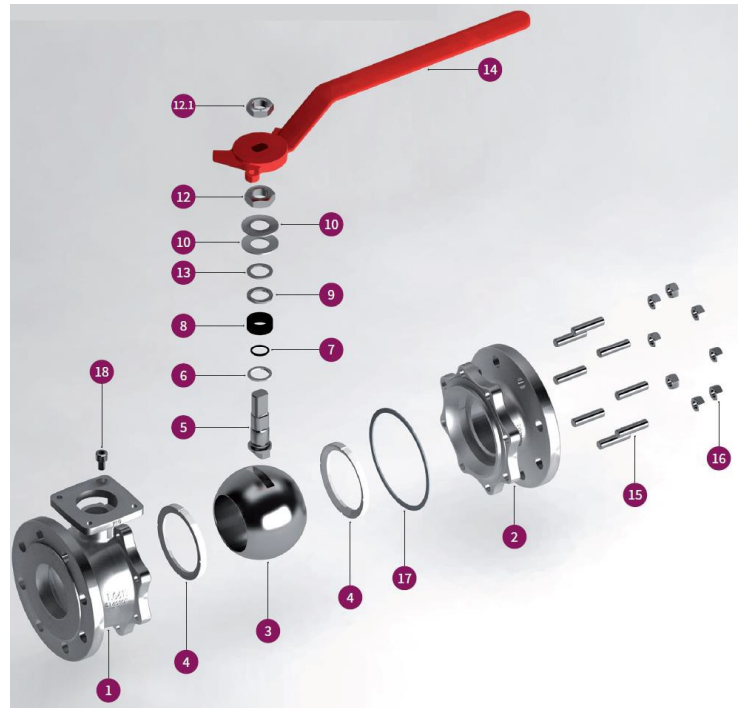

ADDITIONAL SPECIFICATIONS

### PRESSURE CHART AND VALVE APPLICABLE STANDARDS

PRESSURE / TEMPERATURE GRAPH ( STEAM EXCLUDED ) :

#### PRESSURE

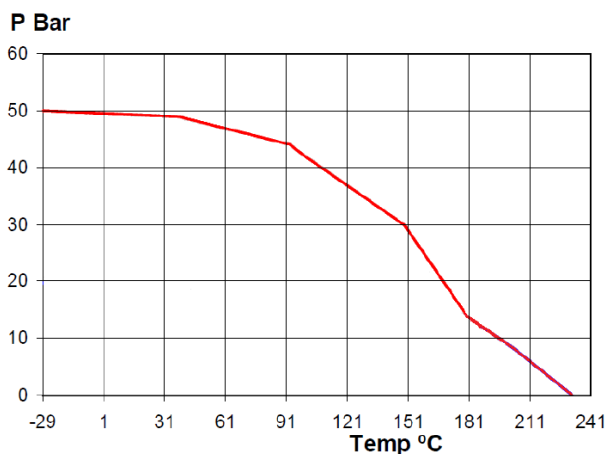

STANDARDS :

- Fabrication according to ISO 9001:2015
- DIRECTIVE 2014/68/EU : CE N° 0035 Risk Category III module H
- Certificate 3.1 on request
- Valve designing according to EN 1983 – ISO 17292 and ASME B16.34
- Materials according to NACE MR 01-75
- Pressure Tests according to EN 12266-1, Rate A and API 598
- Marking according to EN 19
- Fire safe according to ISO 10497 : 2004
- Fugitive Emissions according to EN 15848-1 : 2006
- Class 300 (PN50) Flanges R.F. according to ASME B16.5
- ISO 5211 mounting pad and stem size according to EN 15081
- Length according to ASME B16.10 (EN 558 series 4 up to DN150)
- ATEX Group II Category 2 G/2Dc Zone 1 & 21 Zone 2 & 22 ( optional marking ) according to directive 2014/34/EU



T +44 (0)1386 552369

E sales@allvalves.co.uk

W www.allvalves.co.uk

F +44 (0)1386 554227