



Main Features:-

- ◆ Needle Valve
- ◆ 1/4" to 2" PN3000
- ◆ Threaded ends female, ISO 228/1 (BSP)
- ◆ 1/4"-1/2" = 260 °C. 3/4"-1 1/4" = 240 °C. 1 1/2" - 2" = 200 °C

*Temperature and pressure determined by valve body, seat etc.

Suitable Applications & Approvals:



HVAC



OIL



GAS



INDUSTRY



SERIES: 80236

MANUFACTURER: **GENEBRE**

VALVE MATERIALS

ITEM	SECTION	MATERIAL	ADDITIONAL INFO / OPTIONS
1	Body	≤ 1": ASTM A479-04	≥ 1 1/4": ASTM A182 F316
2	Bonnet	AISI 316	n/a
3	Nut	AISI 316	n/a
4	Needle	A182 F6	Nitrogen Treatment
5	Stem	ASTM A182 F316	n/a
6	Stem Packing	PTFE + Graphite	n/a
7	Packing Nut	SS 316	n/a
8	Handwheel	Cast Iron	Painted
9	Nut	SS 304	n/a
10	Washer	SS 304	n/a

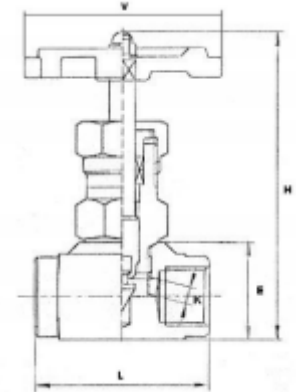
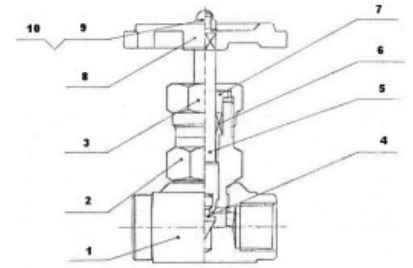

REF	SIZE	PN	E	H	L	K	V	Kg
80236-02	1/4"	3000	25	85	50	3	63	0.26
80236-03	3/8"	3000	30	100	55	4	63	0.36
80236-04	1/2"	3000	34	115	60	6	72	0.53
80236-05	3/4"	3000	40	120	70	8	72	0.76
80236-06	1"	3000	45	138	75	9	80	1.175
80236-07	1 1/4"	3000	57	165	90	11	100	1.85
80236-08	1 1/2"	3000	67	185	100	15	120	2.9
80236-09	2"	3000	78	195	120	18	140	4.7

T +44 (0)1386 552369

W www.allvalves.co.uk

E sales@allvalves.co.uk

F +44 (0)1386 554227





Genebre are a global brand of industrial valves with large stocks held for fast delivery on various type of valves, sizes, end connections and materials.

SERIES: 80236

REF

SIZE

Kv

KV VALUES:

80236-02	1/4"	0.25
80236-03	3/8"	0.36
80236-04	1/2"	0.47
80236-05	3/4"	0.95
80236-06	1"	1.1
80236-07	1 1/4"	1.6
80236-08	1 1/2"	4.76
80236-09	2"	5.36

- The Kv values (M3 per hour) is the flow of water at a temperature of 5C to 30C (41F to 86F) at p of 1 bar

- For further information, please email sales@allvalves.co.uk

TORQUE / Kv VALUES / DIMENSIONS

PRESSURE TEMPERATURE RATING

GENEBRE

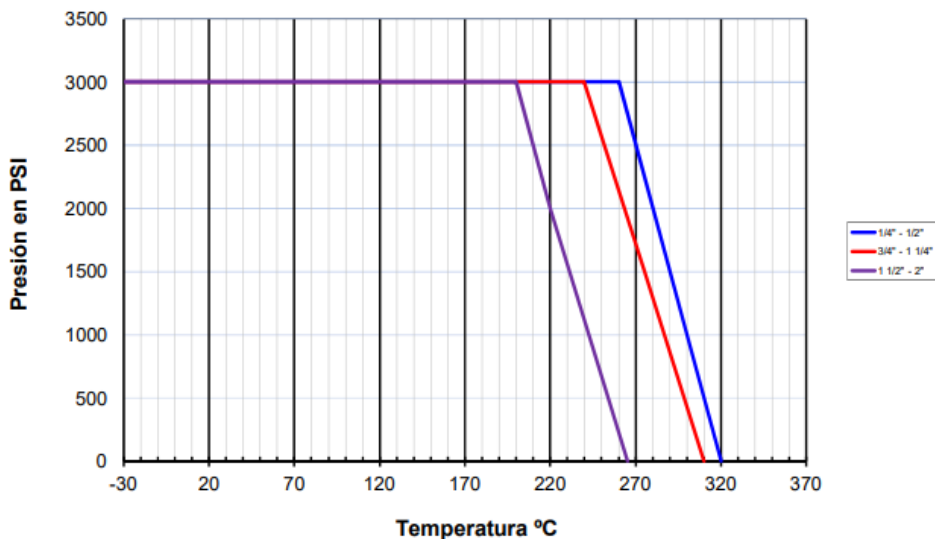

Genebre is a leading company and world reference in fluid control and high-quality taps. They control all the creation processes, responding to the specific needs of each market: from the initial concept and design of the product to the production and commercialization.

ALL VALVES

Offering a full range of actuated valve packages, manual valve range, pipe fittings and pumps, we have a product for all your requirements. As an ISO 9001-2015 Quality Approved and certified company, All Valves offer a quality service from pre-sale to post sale. Shipping millions of pounds in value of manual valve and actuated valve packages all over the world since its formation, All Valves are a trusted valve and actuator supplier to many companies all over the world. Working with the leading brands in most industries.



T +44 (0)1386 552369

E sales@allvalves.co.uk

W www.allvalves.co.uk

F +44 (0)1386 554227